



# Trussbilt

## Metal Security Ceiling Systems



**SecureDek**



**BarrierDek**



**TrussDek**

***Leading Innovator of Security Products for Over 80 Years***



**Trussbilt**

# **Acoustical Metal Security Ceiling Systems**

Trussbilt's Acoustical Metal Security Ceiling Systems meet the full range of security ceiling requirements, from supervised areas of minimum and medium security facilities through in-cell use in maximum security applications. And, they address the growing need to control noise in the detention setting, which creates not only a poor living environment for inmates, but also a stressful and unsafe working environment for correctional officers.

In addition to absorbing sound, Trussbilt ceilings conceal and protect plumbing, electrical and HVAC facilities. And, their unique snap-in secure lock system means they are twice as fast to install as screwed-in metal ceilings, lowering construction costs. Because Trussbilt ceiling systems are all steel, maintenance and replacement costs are dramatically reduced over the life of the building. Their life cycle costs are the lowest in the industry.

Trussbilt manufactures all access panels to ensure seamless integration with other trades. And, Trussbilt's ceiling systems can be used with their unique TrussWall product for a single source, integrated security package that allows you to realize even more savings on your project, both at time of construction and over the life cycle of the facility.

## **SecureDek** Metal Pan Ceiling



## **BarrierDek** Single Skin Metal Plank Ceiling



## **TrussDek** Double Skin Metal Plank Ceiling



*"Our field installation crews have offered nothing but praise and high-marks for the ease of installation and uniformity of your product. This of course leads to cost savings in labor while providing opportunity to improve on construction schedules. In addition, the owners and end users of these facilities have all been impressed with the clean lines and unique detail offered in the finished product."*

**G. Lee Cummings, Project Manager**  
**Norment Security Group, Inc.**

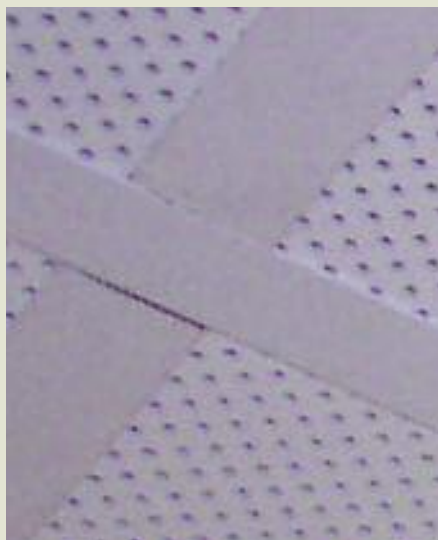

**SecureDek** is an acoustical ceiling system **for supervised areas of minimum and medium security** corrections facilities. The system is constructed of standard 2' x 2' or 2' x 4' metal pans with a heavy-duty exposed grid. SecureDek is also available in aluminum and stainless steel for high-moisture, sanitary areas.



**BarrierDek** provides a physical security barrier combined with excellent noise reduction **for medium and maximum security areas** that are not directly supervised. The construction consists of 12", 18" or 24" wide by 8', 10' and 12' long single layer metal planks supported by perimeter and "T" angles. BarrierDek, like SecureDek, is also available in aluminum and stainless steel.



**TrussDek**, the most secure ceiling system available today, is designed **for the most demanding security requirements**. Able to withstand attack from the most violent offenders, it is used in inmate cells and segregation units. The construction consists of 18" or 24" wide double layer metal planks with Trusscore center. The system is supported by perimeter and "T" angles. TrussDek integrates with Trussbilt's TrussWall system inside the cell.





Trussbilt

# SecureDek Metal Pan Ceiling System

The **SecureDek** metal pan ceiling system is a low-maintenance security acoustical ceiling system composed of 18 gauge galvanized perforated steel panels, 2' x 2' or 2' x 4'. Its panels securely snap into a heavy-duty steel grid with vertical steel compression struts, cutting installation time. Panels are filled with a poly-wrapped fiberglass acoustical blanket to provide high sound absorption values. And, Trussbilt manufactures all access panels for seamless integration with all trades.

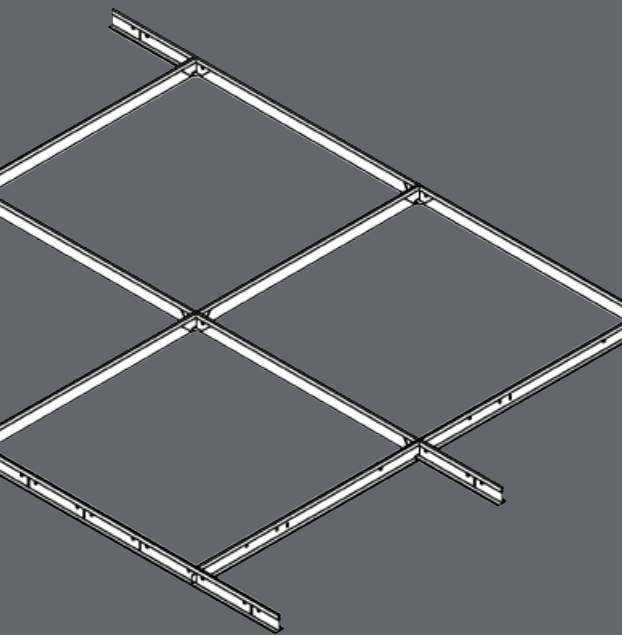

## **SecureDek Metal Pan Ceiling Systems offer:**

### **Security**

- ☐ Tamper-proof assembly
- ☐ 18 gauge panels
- ☐ All steel components

### **Acoustical Properties**

- ☐ NRC (Noise Reduction Coefficient) up to .95
- ☐ Poly-wrapped fiberglass acoustical blankets

### **Quality Finish**

- ☐ White TGIC polyester powder coat finish
- ☐ Durability and cleanability
- ☐ Superior light reflectivity

### **Versatility**

- ☐ Perforated and non-perforated panels
- ☐ Stainless steel and aluminum also available for high-moisture and sanitary areas

### **Options**

- ☐ Access panels
- ☐ Special finish colors

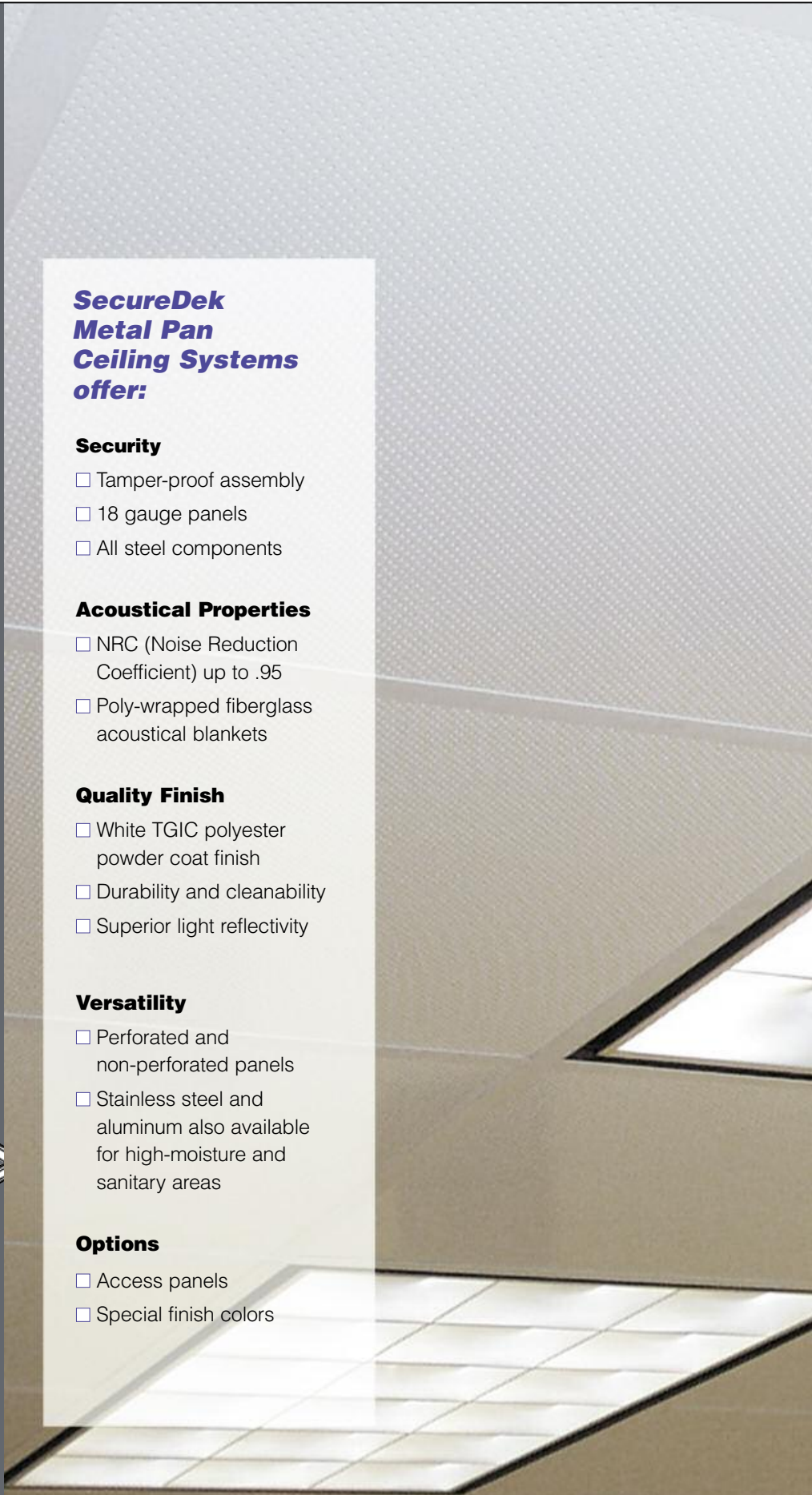

***"We chose Trussbilt because of their many years in the business and the high quality of their product. Their experience was an invaluable asset to our design team, as they customized their system to suit our client's needs and provided a high quality detention system at a great price. The quick erection time and perfect fit of the components helped us to complete the project ahead of schedule."***

***Scott Gellner, Project Manager, and  
Glyn Slattery, Senior Project Manager, Lydig Construction***

***"I have over 15 years of experience with Trussbilt working on my projects throughout the country. I cannot remember a single time where Trussbilt failed to deliver its products on time. Nor can I remember a case where Trussbilt appeared the least bit reluctant to correct a minor deficiency. In fact, I have found Trussbilt very cooperative and willing to be a partner and part of the solution for the many challenges facing designing and building our nation's jails and prisons."***

***Bill Prindle, LEED A.P., Senior Vice President, HOK***

### **SecureDek Attaching to Existing Wall**

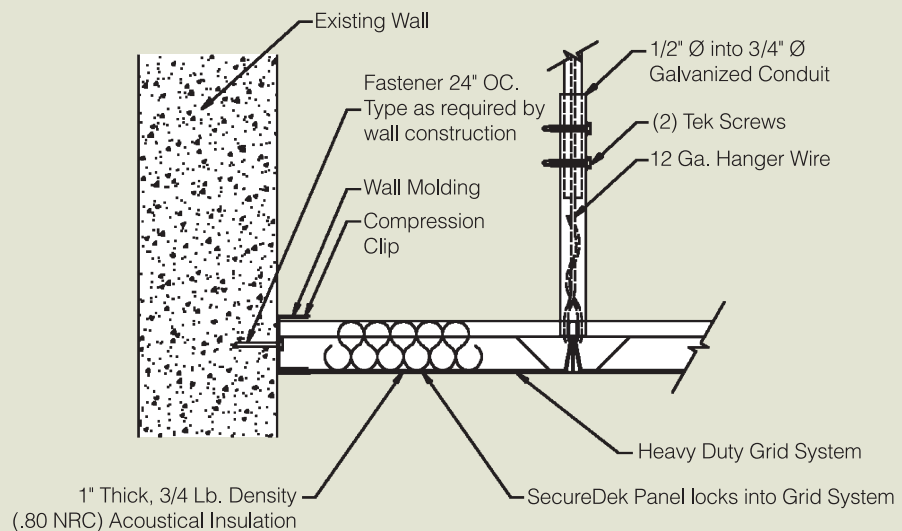

### **SecureDek Ceiling System Structure**

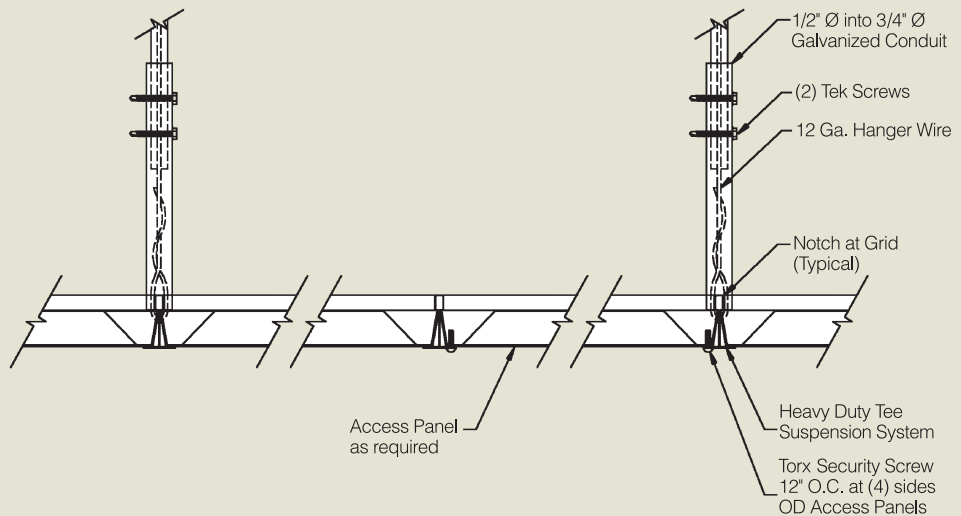



Trussbilt

# BarrierDek Metal Plank Ceiling System

The **BarrierDek** metal plank ceiling system provides an effective security barrier combined with excellent acoustics. The interlocking, single layer panels provide great resistance to passage or attack in applications such as:

- Lobbies and corridors
- Detention dayroom ceilings
- Holding areas
- Visitation areas
- Inmate cells
- Hospital secure areas
- Museums
- Pharmacies
- Gymnasiums and high noise areas
- Burglar-vulnerable areas

The factory finished, powder coated panels are constructed of (A40) galvanized steel and are strong, attractive and moisture resistant. The panels slip into place and are interlocked together, supported by perimeter and "T" angles. No supplemental screw fastening is required, speeding installation time. The interlocking design, TrussLok, physically links the panels together in a formed shape, precluding passage of objects. Trussbilt manufacturers all access panels to ensure seamless integration with other trades.

BarrierDek can be used with Trussbilt's TrussWall product for an integrated, single source system, cutting costs at construction and over the life of the facility.

## **The BarrierDek Metal Plank Ceiling Systems offer:**

### **Security**

- ☐ Interlocking design
- ☐ Tamper-proof assembly
- ☐ 16, 14 and 12 gauge panels (16 gauge is standard)
- ☐ All steel components

### **Noise Reduction**

- ☐ NRC (Noise Reduction Coefficient) up to 1.00
- ☐ Poly-wrapped fiberglass blankets

### **Quality Finish**

- ☐ White T.G.I.C. polyester powder coat finish
- ☐ Durability and cleanability
- ☐ Superior light reflectivity

### **Versatility**

- ☐ Perforated and non-perforated panels
- ☐ Stainless steel or aluminum available
- ☐ Widths of 12", 18" and 24"
- ☐ Lengths of 8', 10' and 12'

### **Options**

- ☐ Medium security screw-type access panels
- ☐ Medium and maximum security access panels with lock
- ☐ Backer panels
- ☐ Special finish colors
- ☐ "C" style panels
- ☐ Soffits
- ☐ Panels cut to length
- ☐ Factory cut-outs
- ☐ Light fixture mountings





**"BarrierDek's interlock system provides a secure ceiling with ease of installation, saving valuable time at the site."**

**George Mitchell, Owner, Mitchell Construction**

**"I have been fortunate to work with Trussbilt on a number of successful projects in the corrections industry over the past decade. Trussbilt has proven to be a company that performs at the highest level by delivering a quality product in a very demanding industry."**

**F. Wally Riffle, Architect, R & N Systems Design, LLC**

### **BarrierDek Plank Ceiling System Structure**

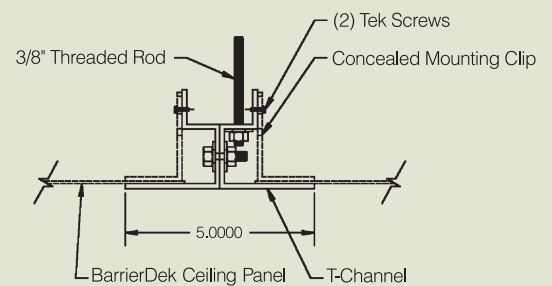
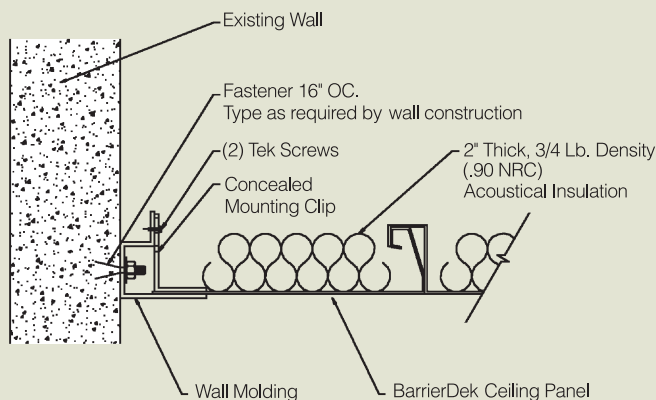
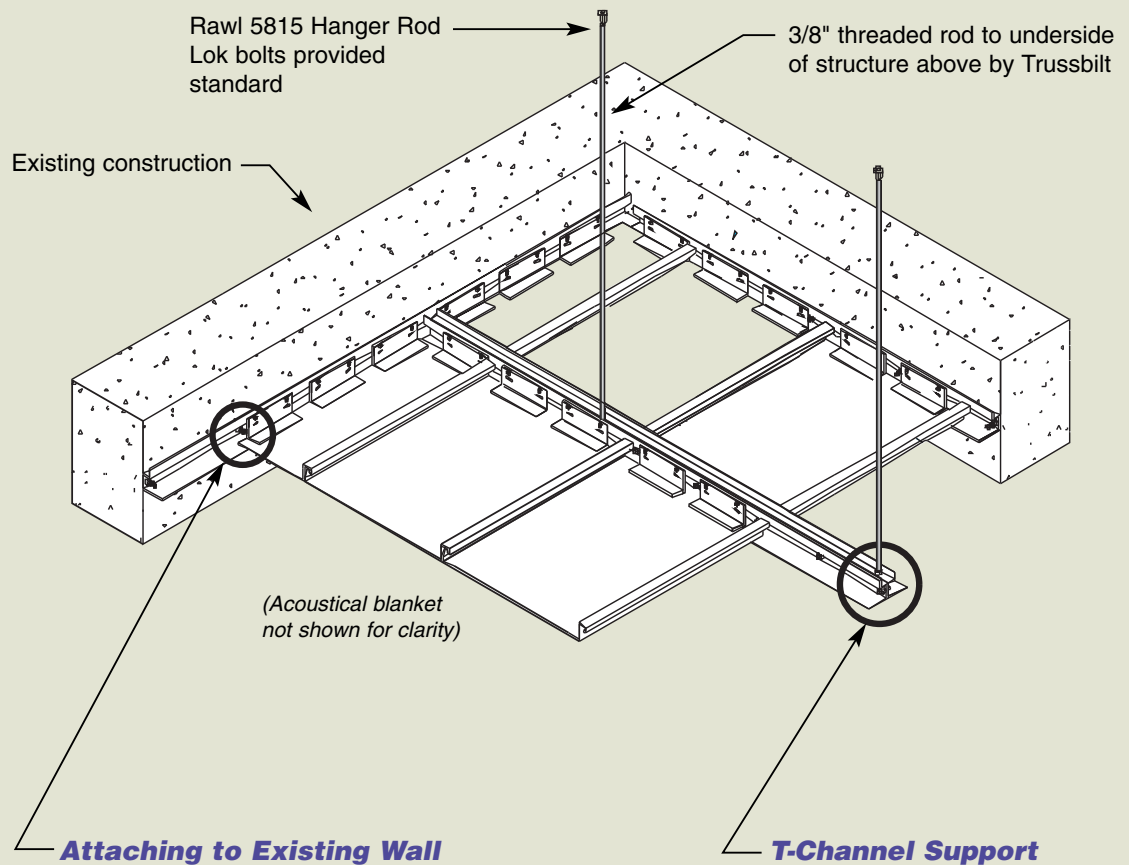



Trussbilt

# TrussDek Metal Plank Ceiling System

**TrussDek**, a metal plank ceiling system that provides a maximum security barrier combined with excellent acoustics, is the most secure ceiling system available today. Double layer panels combined with a Trusscore center provide superior resistance to passage or attack in applications such as:

- Inmate cells
- Holding areas
- Detention dayroom ceilings
- Security corridors
- Soffit enclosures
- Wall separators
- Acoustical wall panels

The prime-coated panels are the strongest and most secure product on the market. The panels slide into place and are welded together to provide a secure environment. The shi lap design makes installation quick and easy while preventing the concealment of contraband. The all-steel construction allows placement of accessories and utilities where they are needed, eliminating the need to frame around penetrations. They are supported by perimeter and "T" angles.

Trussbilt manufactures all access panels to ensure seamless integration, reduce coordination efforts, and save installation time. And, TrussDek can be used with Trussbilt's TrussWall product for an integrated, single source system, cutting costs at the time of construction and over the life of the facility.

## **TrussDek Metal Plank Ceiling Systems offer:**

### **Security**

- ☐ Interlocking ship-lap joint design with Trusscore center
- ☐ Tamper-proof assembly
- ☐ All steel components
- ☐ 16, 14 and 12 gauge

### **Noise Reduction**

- ☐ NRC (Noise Reduction Coefficient) up to .75

### **Quality Finish**

- ☐ Prime coat finish
- ☐ Durability and cleanliness

### **Versatility**

- ☐ Perforated and non-perforated panels
- ☐ Stainless steel available
- ☐ Standard widths of 18" and 24"
- ☐ Standard lengths of 6', 8' and 10'

### **Options**

- ☐ Security access panels with lock
- ☐ Soffits
- ☐ Custom sized available
- ☐ Factory cut-outs
- ☐ Light fixture mountings

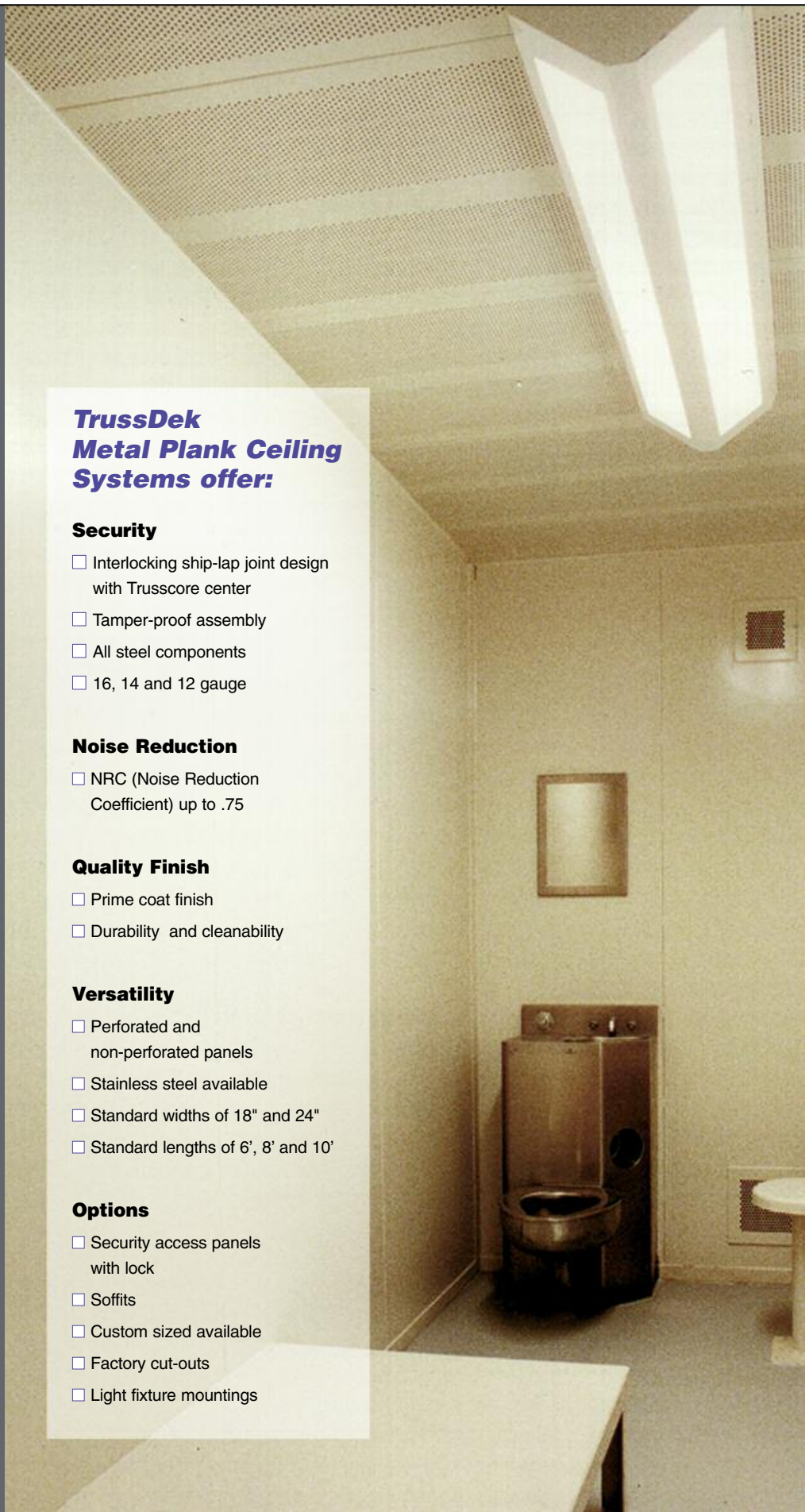



***"Trussbilt consistently delivers high quality products at competitive prices, and they deliver them on time. If they make a mistake, they accept responsibility and take immediate action to correct it. I don't think you can ask for more out of a company."***

***Randy DeMent, Division Manager  
Detention Systems Division, CCC Group Inc.***

***"I have been using Trussbilt products in my correctional facility designs for over 25 years. Their product quality is exceptional and among the best in the industry. Trussbilt reliability and integrity make them an exemplar in the detention hollow metal products industry."***

***Joseph F. Haines, AIA, Senior Principal, DLR Group, Inc.***

### **TrussDek Plank Ceiling System Structure**

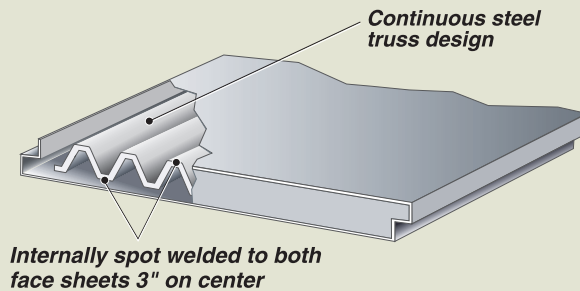

### **Attaching to Existing Wall**

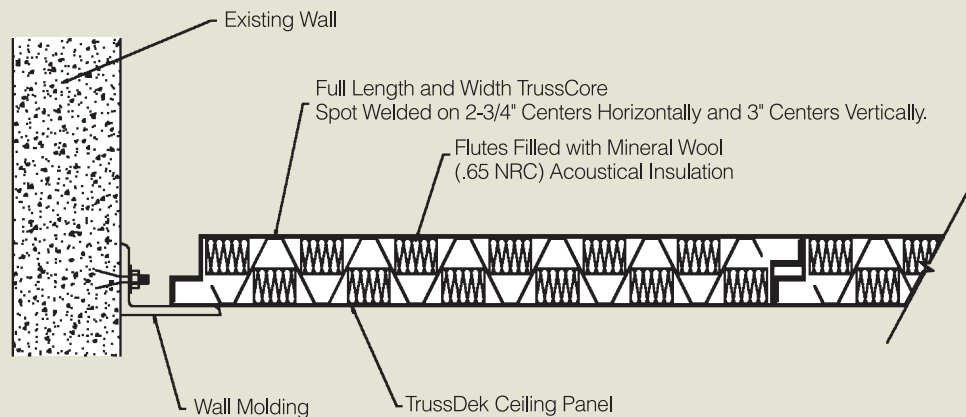

### **T-Channel Support**

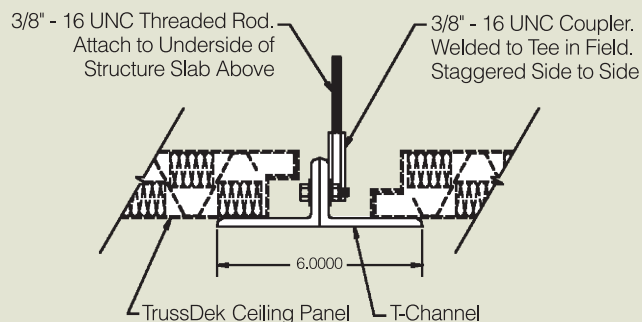

**SecureDek** Metal Pan Ceiling



**BarrierDek** Single Skin Metal Plank Ceiling



**TrussDek** Double Skin Metal Plank Ceiling









## **Leading Innovator of Security Products for Over 80 Years**

Trussbilt has designed and manufactured high quality security products since 1926. Trussbilt's products are used in over 2,000 prisons throughout the world.

- TrussWall Security Walls
- Security Ceilings
- Detention Doors and Frames
- Safe-T-Feed Food Pass System
- Detention Furnishings

We have developed and pioneered performance tests that demonstrate the superiority of hollow metal fabrication for security. Trussbilt's racking load test, static load test, impact test and edge crush load test have become industry standards.

Our expertise and experience position us as the detention industry's market leader.

### **ISO 9001:2000 Certified**

The product detail and specification information provided herein reflects past experience and is for reference purposes. Trussbilt reserves the right to modify designs and specification requirements. Details will be provided to meet project specification requirements or upon request for specific applications.



# **Trussbilt**

[www.trussbilt.com](http://www.trussbilt.com)

### **GENERAL OFFICES**

550 Oak Grove Parkway  
Vadnais Heights, MN 55127-8509  
TEL: 651.633.6100  
FAX: 651.633.7100

### **MANUFACTURING FACILITIES**

**Main Plant**  
555 Lincoln Avenue NW  
Huron, SD 57350  
TEL: 605.352.5283  
FAX: 605.352.7141

**North Plant/Ceiling Products**  
801 Lincoln Avenue NW  
Huron, SD 57350  
TEL: 605.352.7096  
FAX: 605.352.7153